

Johns Hopkins University School of Medicine **Wood Basic Science Complex**

Map Courtesy of **JHU SOM Microscope Facility**, Physiology G04, 725 N Wolfe St, Baltimore MD 21205
<http://www.hopkinsmedicine.org/micfac/> tel: 410-614-6890

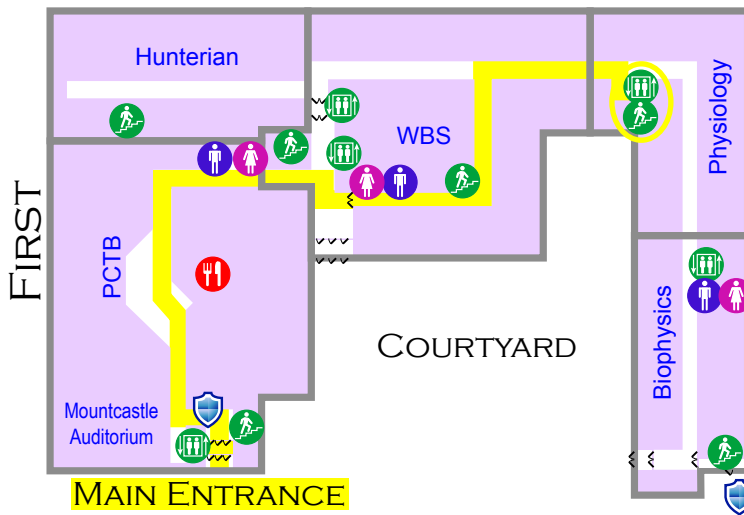

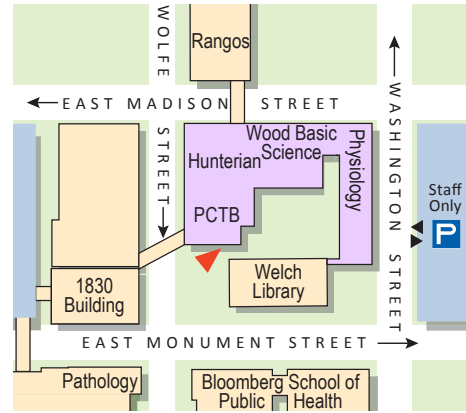

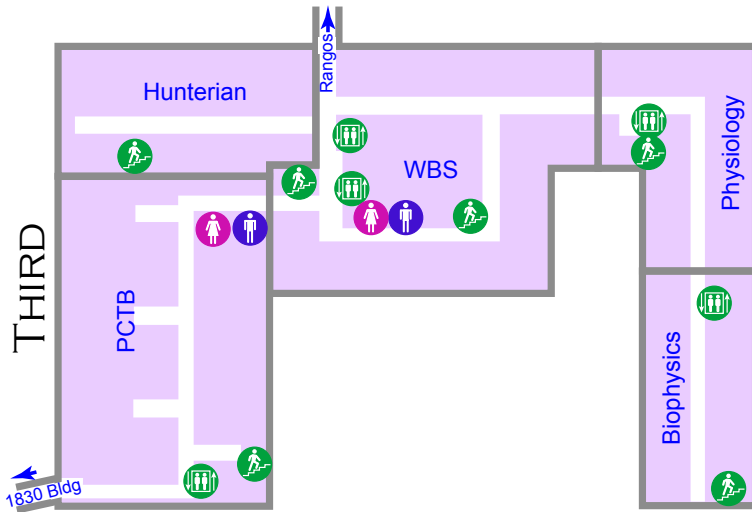

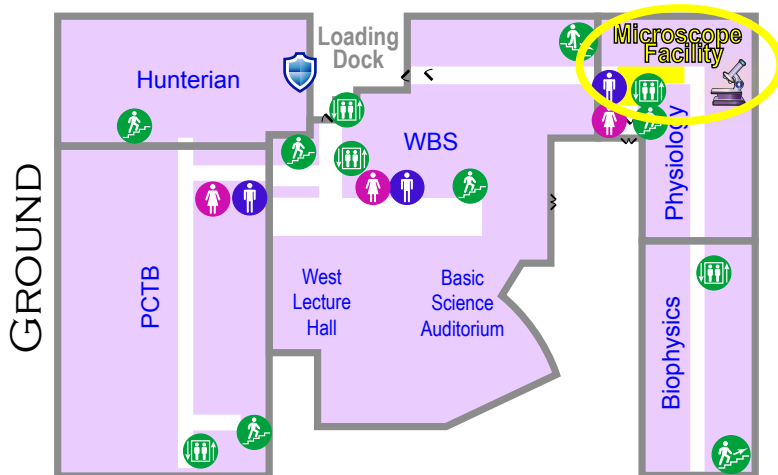

How to get to the JHU SOM Microscope Facility offices
 (tel: 410-614-6890, Physiology G04 & WBS G10)

Do **not** use the triple elevators or stairs in WBS Building. Visitors **cannot** get to the Facility on the Ground floor from this side of WBS Building.

Instead, go **through** the double doors around the corner to the **right** of the triple elevators. Proceed through WBS Building into the Physiology Building.

Take the elevator or stairs in Physiology Building down to the Ground floor. The Facility is to the right.



-  Security
-  Elevators
-  Stairs
-  Restrooms
-  Dining